

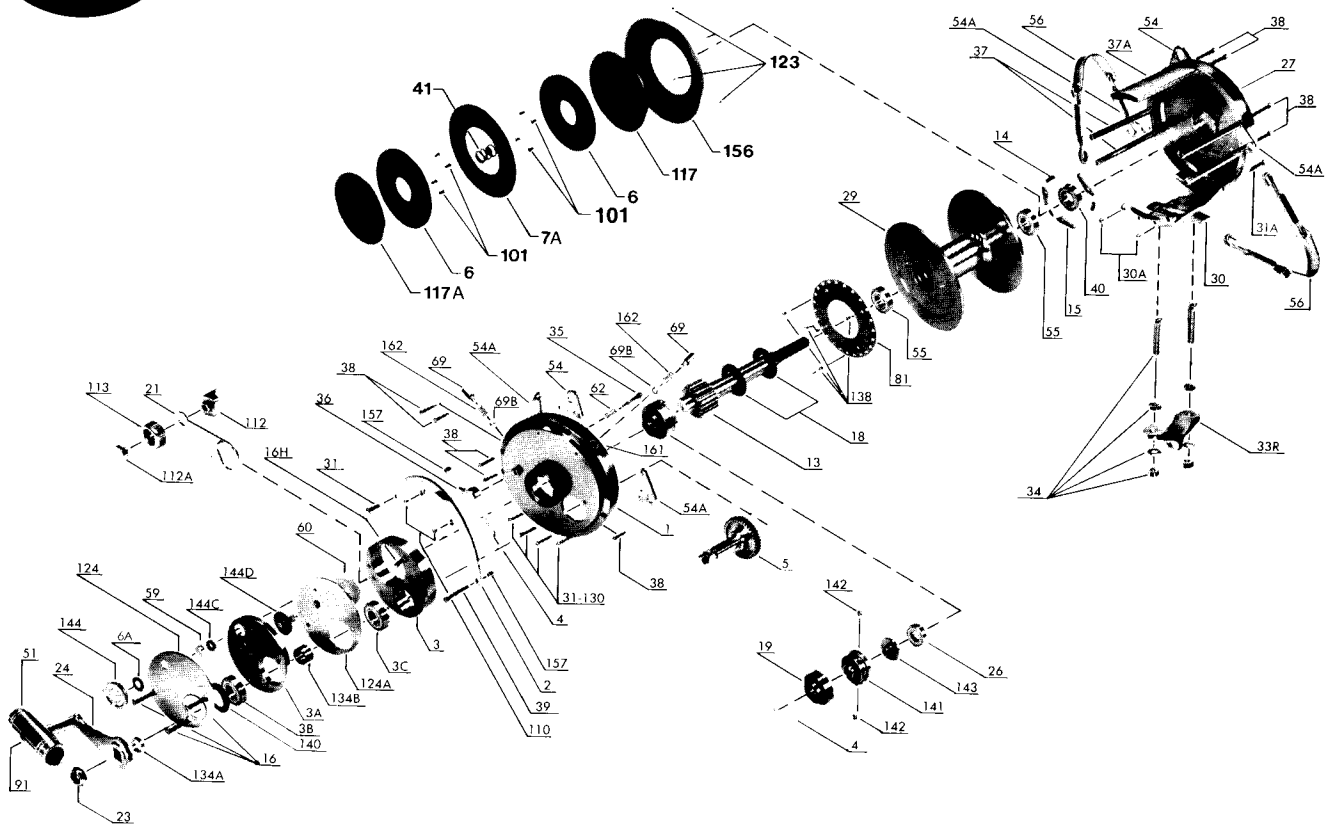

## PARTS AND PRICE LIST FOR INTERNATIONAL 130 AND 130H



Key No.	Part No.	Description	Price	Key No.	Part No.	Description	Price
1	1-130	Right Side Plate Assembly	\$125.65	39	39-130	Special Post Screw (1)	\$.70
2	2-130	Quadrant Ring	11.90	40	55-130	Left Side Bearing (1)	21.00
3	3-130	Bridge (Inner)	12.65	41	41-130	Left Side Bearing Spring	.85
3A	3A-130	Bridge (Outer)	10.35	51	51-130	Handle Knob	11.90
3B	55-130	Bridge Bearing (Outer)	21.00	54	54-130	Harness Lugs (2)	2.15
3C	55-130	Bridge Bearing (Inner)	21.00	54A	54A-130	Rod Brace Lugs (2)	2.15
4	4-130	Cam Thrust Washer	1.05	55	55-130	Spool Bearings (2)	21.00
5	5-130	Main Gear	26.45	56	56C-117	Rod Brace (Complete)	14.00
	5-130H	Main Gear	26.45	59	59-130	Slotted Washer	.60
6	6-130	Drag Washer	12.95	60A	60A-130	Backing Washer	1.05
6A	6-155	Leather Spacing Washer	.50	62	62-50	Click Spring	.70
7A	7A-130	Floating Drag Washer	14.05	69	69-130	Locating Pins (2)	1.35
13	13-130	Pinion Gear	45.65	69B	69B-130	Retaining Rings (2)	.70
	13-130H	Pinion Gear	45.65	81	81-130	Ratchet	7.95
14	49-710	Dog Springs (3)	.40	91	91-130	Handle Shaft	4.65
15	15-130	Dogs (3)	.85	95	95-130	Click Tongue Bushing (N/S)	2.60
16	16-130	Bridge Mounting Screw (Outer) (3)	.45	95B	38-710	Click Bushing Nut (N/S)	.45
16H	16H-130	Bridge Mounting Screw (Inner) (1)	.45	101	118-80S	Drive Plate Screws (8)	.45
18	18-130	Clutch Springs (2)	.95	110	110-50	Center Quadrant Screws (4)	.40
18A	95A-20	Click Bushing Washer (N/S)	.50	112	112-130	Eccentric Lever Knob	7.85
19	19-130	Eccentric Cam	10.70	112A	112A-130	Eccentric Knob Screw	1.30
21	21-130	Eccentric Cam Lever	7.70	113	113-130	Eccentric Lever Cap	3.60
22	50-704	Dog Screws (3)	.40	117	117-130	Drive Plate (Outer)	18.35
23	23-130	Handle Nut	2.90	117A	117A-130	Drive Plate (Inner)	16.35
24	24-130	Handle Complete	37.75	123	123-50	Drag Cover Screw	.35
26	55-130	Right Side Bearing	21.00	124	124-130	Bridge Cover (Outer)	7.45
27	27-130	Left Side Plate	112.00	124A	124A-130	Bridge Cover (Inner)	6.90
29	29L-130	Spool	171.00	134A	134A-130	Handle Spacing Collar	1.70
30	30-130	Stand	55.00	134B	134B-130	Bearing Spacing Bushing	1.05
30A	30A-130	Dowel Tube (6)	.75	138	101-30	Ratchet Screws (4)	.40
31A	31-130	Stand Screws (6)	.45	140	140-115	Felt Washer	.45
31	16H-130	Quadrant Screw (1)	.45	141	141-130	Cam Follower	7.85
33R	33R-130ST	Ringed Rod Clamp	18.50	142	142-130	Cam Follower Pins (2)	.45
34	34-116	Rod Clamp Screw w/Nuts	5.90	143	143-130	Adjusting Screw	6.90
35	35-130	Click Tongue	2.15	144	144-130	Pre-Set Knob	7.00
36	36-50	Click Button	2.00	144C	144C-130	Pre-Set Pinion	1.60
36A	36-700	Click Button Nut (N/S)	.70	144D	144D-130	Pre-Set Gear	3.75
37	37-130	Frame Post	3.45	156	156-130	Drag Cover	6.60
37A	37A-130	Spacer Bar	17.95	157	157-130	Quadrant Bushing Spacer (2)	.45
	37A-130H	Spacer Bar	17.95	161	161-130	Stop Pin Bushings (2)	1.35
38	38-130	Post Screw (11)	.45	162	162-130	Stop Pin Springs (2)	.40